

Overall length	58 feet
Beam	6 feet 10 inches
Draft	2 feet 1 inches
Headroom	--
No. of berths	2
Style of stern	
BSS certificate expiry	--
Built	In 2005 by Liverpool Boat Company
Fitout	In 2005 by Liverpool Boat Company
Base	
Hull	Steel
Cabin	
Engine	Isuzu Isyuzu35
Gearbox	Newage Transmissions PRM120D2

Yaya

Springwood Haven Marina

£55,999.00

A 58ft 2005 Liverpool Boats 2 berth cruiser stern narrowboat

Welcome aboard Yaya, a beautifully designed modern home on the water, offering a stylish yet practical layout that instantly feels like home.

Step inside to discover a light and airy double bedroom, thoughtfully arranged with a stand-up wardrobe and full-length mirror, perfect for relaxed mornings and cosy nights. Adjacent to the sleeping area, you'll find a cleverly enclosed utility section housing a washing machine and four cube storage boxes.

The modern bathroom boasts a full-sized washbasin with built-in storage, a sleek round mirror that enhances the sense of space, and a contemporary grey-accented shower with sliding glass doors and an adjustable head. A waterless composting toilet adds to Yaya's eco-friendly appeal. Finishing touches like built-in shelves and panelled wood flooring bring warmth and character to the space.

Next, step into the heart of Yaya the galley kitchen. The galley is fully equipped with a 4-burner hob, oven with grill, microwave, and a stylish round sink with matching round drainer. Crisp white cupboards offer generous storage for utensils and groceries, while an optic holder adds a fun touch for hosting. At the end of the galley, you will find a breakfast bar with two high cream chairs invites conversation, making it a great space to dine, observe, and socialise.

The final cabin is the saloon area which is a comfortable and inviting space to relax. It features a good-sized sofa, a shelf ready for a TV, and a wood-burning stove newly installed in May 2025. There's also room to add a side table. The soft cream carpet adds a subtle, elegant touch





to the room, while the wood flooring that runs throughout the boat ties the spaces together with warmth and style.

Step outside to the bow area, an ideal spot to enjoy morning coffee.

To arrange a viewing for Yaya please contact our Springwood Haven Marina on 02476 393676.

Additional information

Huawei Router included

Washing Machine Beko included

Scan the QR code to view online









ABC Leisure Group Ltd Reg. Office: Scarfield Wharf, Alvechurch, Worcestershire B48 7SQ Reg. No. 2860394. Whilst every care has been taken in their preparation, the correctness of these details is not guaranteed. They are intended as a guide only and do not constitute a term of any contract. A prospective buyer is strongly advised to check the particulars and where appropriate to employ a qualified marine surveyor to inspect the vessel.

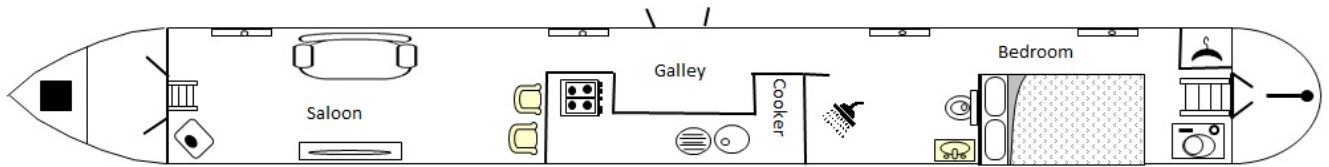



General

General

Name	Yaya
BW index number	511629
Safety certificate	YES
BSS certificate expiry	--
BSS certificate number	BSSER-451284/23
Built	In 2005 by Liverpool Boat Company
Location	Springwood Haven Marina
Price	£55,999.00

Berths

No. of Berths	2
Double beds	1
Double beds (temp)	--
Single beds	--
Single beds (temp)	--

Size

Overall length	58 feet
Overall beam	6 feet 10 inches
Overall draft	2 feet 1 inches
Style of stern	

Structure

Manufacturer

Manufacturer	Liverpool Boat Company
Hull ID No.	--
Build date	2005

Original steel thickness

Base	--
Hull	--
Cabin	--

Anodes

Fitted	NO
Date fitted	--
Size	--
No. of anodes	--

Material

Base	--
Hull	Steel
Cabin side	--
Roof	--

Hull blacking

Last hull blacking	2023/06
Where	Springwood Haven Marina



**Running gear****Engine**

Make	Isuzu
Model	Isyzu35
Year	--
Fuel	Diesel
Cooling	--
Hours	--
Last serviced date	2024/03
Last serviced by	John Noriega

Gearbox

Make	Newage Transmissions
Model	PRM120D2
Year	--
Reduction	--
Coupling	--
Shaft diameter	--
Propellor size	--

Capacities

Fuel	135 Ltrs
Water	545 Ltrs
Gas type	LPG

No. of gas cylinders	2
Gas cylinder size	13Kg

Interior**Fitted**

Fitted by	Liverpool Boat Company
Date fitted	2005

Materials used

Floor	Wood
Hull sides	Insulation foam
Cabin sides	Wood
Deckhead	Steel
Bulkheads	--
Fittings	--



**Equipment****In the galley**

Cooker type	--
Cooker model	--
Fridge type	Whirlpool
Fridge model	UBGHJ604
Other	Washing machine Beko - WTB720E1W Freezer in fridge

Heating

Type	Wood burner
Make	Clarke
Model	3
Fuel	Wood
Other remarks	Woodburner purchased in May 2025

Hot water

Type	Eberspacher
Make	--
Model	--
Fuel	Diesel
Other remarks	Eberspacher last serviced 2024
Additional heating	4x Radiators onboard

In the bathroom

Bath	--
Shower	Yes
Hip bath	--
Basin	Yes
Toilet type	waterless composting
Toilet make	Simploo
Toilet model	--
Toilet tank capacity	--
Toilet remarks	Shower has plastic screen

Electrical systems

DC voltage	--
No. of batteries (start)	1
No. of batteries (domestic)	5
Split charging	--
Other	--

240 volt electrical systems

Inverter make	Edecoa ROHS
Inverter rating	--
Generator make	--
Generator rating	--
Shoreline	NO
Other	--

Additional information

Huawei Router included Washing Machine Beko included
--

