



Westering

Gayton Marina

£52,000.00

A 60ft 2004 Border Boat Builders 4 berth semi-traditional stern narrowboat.

Cutting a fine figure with her sharp blue and white paintwork, Westering will be the envy of the canal.

The hull has been constructed from 10mm thick flat bottom plates, 6mm side plates, 5mm cabin sides and 4mm roof.

Stepping into the first cabin from the stern you will find a double bedroom that also has over-head storage and some drawers. To your right you will find Westering's control panel.

Following through to the bathroom you will find a white tiled corner shower with an adjustable screen, a wash basin and a porta-potti. There is a circular mirror above the wash basin. The bathroom even has room for a washing machine in the unit provided.

Entering into the open plan saloon and galley you will come across a curved dinette area which converts into a double bedroom on the evening.

Next you will have the galley area which has a full sized cooker, with a grill compartment and 4 burner gas hob, an under counter fridge and a sink with drainer. You will also find a shoreline fridge and some storage space under the sink.

The saloon has an open space ready for your choice of furniture and its main feature is the solid fuel stove that sits in the centre to give you a cosy feel in those winter months.

Steps finally lead through double doors to the bow deck which has an 'A' frame.

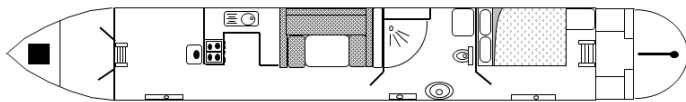

Overall length	60 feet
Beam	6 feet 10 inches
Draft	2 feet 6 inches
Headroom	--
No. of berths	4
Style of stern	
BSS certificate expiry	--
Built	In 2004 by Border Boat Builders
Fitout	In 2004 by Border Boat Builders
Base	Steel 10mm
Hull	Steel 5mm
Cabin	Steel 4mm
Engine	Isuzu Engines Plus 4LE38
Gearbox	Newage PRM PRM 150 D2





There are radiators throughout the boat.

A Boat Safety Certificate is valid till June 2028.

To make an enquiry or arrange to view, please contact Gayton Marina on 01604 858685.

Scan the QR code to view online





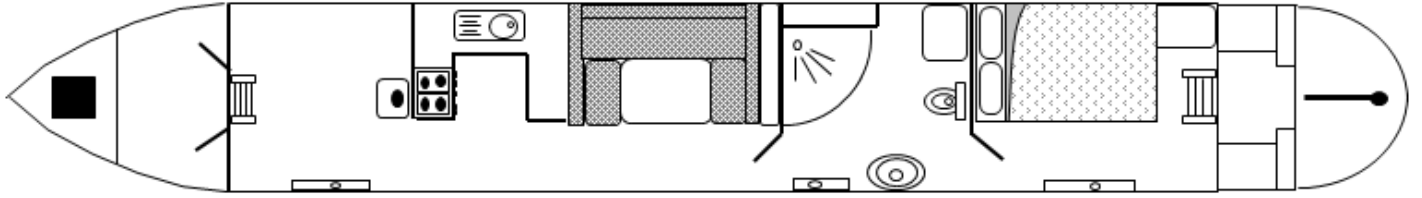

**General**

General

Name	Westering
BW index number	510923
Safety certificate	YES
BSS certificate expiry	--
BSS certificate number	479893/24
Built	In 2004 by Border Boat Builders
Location	Gayton Marina
Price	£52,000.00

Berths

No. of Berths	4
Double beds	1
Double beds (temp)	1
Single beds	--
Single beds (temp)	--

Size

Overall length	60 feet
Overall beam	6 feet 10 inches
Overall draft	2 feet 6 inches
Style of stern	

Structure

Manufacturer

Manufacturer	Border Boat Builders
Hull ID No.	GB-VEN-600IF404
Build date	2004

Original steel thickness

Base	10mm
Hull	5mm
Cabin	4mm

Anodes

Fitted	YES
Date fitted	2017
Size	1.5
No. of anodes	4

Material

Base	Steel
Hull	Steel
Cabin side	Steel
Roof	Steel

Hull blacking

Last hull blacking	2021
Where	R.J. Davis and sons



**Running gear****Engine**

Make	Isuzu Engines Plus
Model	4LE38
Year	2004
Fuel	Diesel
Cooling	--
Hours	--
Last serviced date	May 2024
Last serviced by	Brandon Gazzard (Prime Power)

Gearbox

Make	Newage PRM
Model	PRM 150 D2
Year	--
Reduction	2:1
Coupling	--
Shaft diameter	--
Propellor size	--

Capacities

Fuel	180
Water	400
Gas type	Propane

No. of gas cylinders	2
Gas cylinder size	13KG

Interior**Fitted**

Fitted by	Border Boat Builders
Date fitted	2004

Materials used

Floor	--
Hull sides	--
Cabin sides	Wood
Deckhead	--
Bulkheads	--
Fittings	--



**Equipment****In the galley**

Cooker type	Spinflo Country Leisure
Cooker model	Enigma
Fridge type	Shoreline
Fridge model	RR4655
Other	Washing machine Beko WM5100

Heating

Type	Eberspacher
Make	--
Model	Hydraulic D4/5
Fuel	Diesel
Other remarks	--

Hot water

Type	Calorifier
Make	--
Model	--
Fuel	Heated by calorifier and Engine
Other remarks	--
Additional heating	Morso Squirrel solid fuel stove

In the bathroom

Bath	--
Shower	Yes with plastic screen
Hip bath	--
Basin	Yes
Toilet type	Cassette new in 2024
Toilet make	Excellence
Toilet model	--
Toilet tank capacity	--
Toilet remarks	Spare cassette. Fitting for pump out still in situ.

Electrical systems

DC voltage	12V
No. of batteries (start)	1
No. of batteries (domestic)	3
Split charging	--
Other	--

240 volt electrical systems

Inverter make	Sterling
Inverter rating	--
Generator make	--
Generator rating	1kw
Shoreline	NO
Other	Travel Power 230V AC-16A, Sterling battery charger, Galvanic Isolator 8-40990





Additional information

--

