



Volusia

Alvechurch Marina

£35,000.00

A 57ft 2005 Jonathan Wilson 4 berth traditional stern narrowboat.

Volusia is a charming traditional stern narrowboat looking to have new adventures with a new owner!

As you enter from the stern there is the engine room, perfect for storing boating paraphernalia or personal belongings. Further steps take you down into the double bedroom with a bed with storage underneath and a storage cupboard.

After the bedroom there is a bathroom. This is fitted with a vanity unit, toilet and a screened shower cubicle.

A beautifully appointed galley follows. With its lovely stone tiled floor, the galley comes equipped with sink, washing machine, fridge and a freestanding cooker with a screen cover over the hob. There is also plenty of work top space and under counter storage. A whimsically decorated side hatch can also be opened for extra ventilation.

The last area is an open plan dinette and saloon. Its rich wooden flooring and log burning stove gives this area a cosy feel. The dinette can be converted into a double berth when required.

In addition to the log burner, the boat has electric radiators throughout.

To arrange a viewing or for further information, please contact Alvechurch Marina on 0121 445 1133.

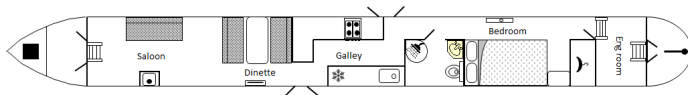

Overall length	57 feet 10 inches
Beam	6 feet 10 inches
Draft	--
Headroom	6 feet 2 inches
No. of berths	4
Style of stern	
BSS certificate expiry	--
Built	In 2005 by Jonathan Wilson
Fitout	Previous owner
Base	Steel
Hull	Steel
Cabin	Steel
Engine	Barrus Shire 40HP
Gearbox	--





Scan the QR code to view online





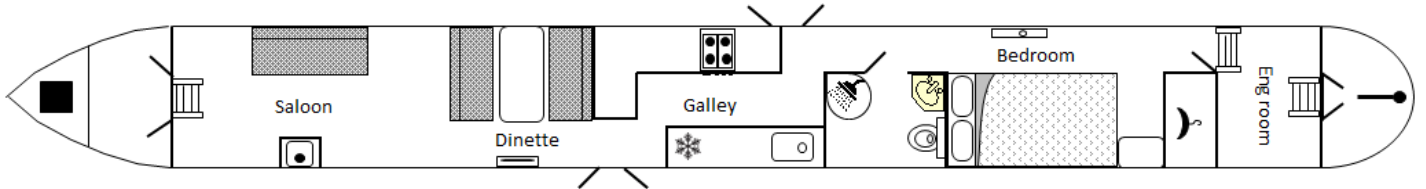

**General****General**

Name	Volusia
BW index number	512912
Safety certificate	YES
BSS certificate expiry	--
BSS certificate number	BSSER-463833/23
Built	In 2005 by Jonathan Wilson
Location	Alvechurch Marina
Price	£35,000.00

Berths

No. of Berths	4
Double beds	1
Double beds (temp)	1
Single beds	--
Single beds (temp)	--

Size

Overall length	57 feet 10 inches
Overall beam	6 feet 10 inches
Overall draft	--
Style of stern	

Structure**Manufacturer**

Manufacturer	Jonathan Wilson
Hull ID No.	JWLTD00090/05
Build date	2005

Original steel thickness

Base	--
Hull	--
Cabin	--

Anodes

Fitted	YES
Date fitted	--
Size	--
No. of anodes	6

Material

Base	Steel
Hull	Steel
Cabin side	Steel
Roof	Steel

Hull blacking

Last hull blacking	--
Where	Alvechurch



**Running gear****Engine**

Make	Barrus Shire
Model	40HP
Year	2005
Fuel	Diesel
Cooling	Water
Hours	--
Last serviced date	--
Last serviced by	Alvechurch Marina

Gearbox

Make	--
Model	--
Year	--
Reduction	--
Coupling	--
Shaft diameter	--
Propellor size	--

Capacities

Fuel	200 litres
Water	460 litres
Gas type	Propane

No. of gas cylinders	2
Gas cylinder size	32kg

Interior**Fitted**

Fitted by	Previous owner
Date fitted	--

Materials used

Floor	--
Hull sides	--
Cabin sides	--
Deckhead	--
Bulkheads	--
Fittings	--



**Equipment****In the galley**

Cooker type	Gas
Cooker model	--
Fridge type	Electric
Fridge model	--
Other	Washing machine

Heating

Type	--
Make	--
Model	--
Fuel	--
Other remarks	--

Hot water

Type	--
Make	--
Model	--
Fuel	--
Other remarks	--
Additional heating	Log Burner in Saloon Electric radiators throughout boat

In the bathroom

Bath	--
Shower	Yes
Hip bath	--
Basin	Yes
Toilet type	--
Toilet make	Actana
Toilet model	--
Toilet tank capacity	--
Toilet remarks	--

Electrical systems

DC voltage	--
No. of batteries (start)	1
No. of batteries (domestic)	6
Split charging	--
Other	--

240 volt electrical systems

Inverter make	Victron
Inverter rating	--
Generator make	--
Generator rating	--
Shoreline	YES
Other	--

Additional information

--

