



Poppy

Springwood Haven Marina

£49,950.00

A 58ft 2005 Black Prince 6 berth cruiser stern narrowboat

Step aboard Poppy, a traditional cruiser stern narrowboat offering a warm and practical layout, ideal for leisurely cruising or extended stays on the water.

Entering from the stern, you will find the first cabin fitted with two single beds, each with convenient storage beneath. Moving forward, the well-appointed shower room features a shower with bi-fold door, a brand-new pump-out toilet, wash basin, mirror, and handy shelving for all your essentials.

Beyond this lies the comfortable main bedroom, complete with a double bed, radiator for year-round comfort, and a full-height wardrobe for clothing.

The heart of Poppy is her spacious open-plan living area. The galley is thoughtfully equipped with a 4-burner hob, grill and oven, under-counter fridge, and a round sink with drainer, everything you need for onboard cooking. Adjacent is a dinette, which can be converted into an additional double bed when hosting visitors.

The saloon has a spacious seating area and leads onto the bow deck, which also has outdoor seating.

A Boat Safety Certificate valid until November 2027.

For more information or to arrange a viewing please contact Springwood Haven Marina on 02476 393676.

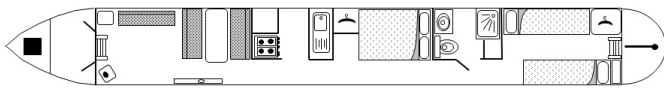

Overall length	58 feet
Beam	6 feet 10 inches
Draft	2 feet 7 inches
Headroom	--
No. of berths	6
Style of stern	
BSS certificate expiry	--
Built	In 2005 by Black prince
Fitout	In 2005 by Shakespeare
Base	Steel 10
Hull	
Cabin	
Engine	Isuzu 42HP
Gearbox	PRM 150





Scan the QR code to view online







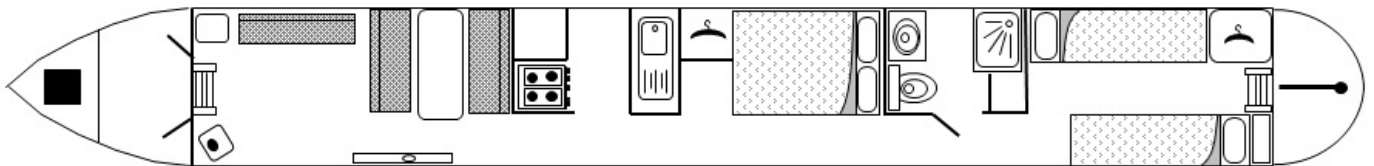



General

General

Name	Poppy
BW index number	513486
Safety certificate	YES
BSS certificate expiry	--
BSS certificate number	46944/23
Built	In 2005 by Black prince
Location	Springwood Haven Marina
Price	£49,950.00

Berths

No. of Berths	6
Double beds	1
Double beds (temp)	1
Single beds	2
Single beds (temp)	--

Size

Overall length	58 feet
Overall beam	6 feet 10 inches
Overall draft	2 feet 7 inches
Style of stern	

Structure

Manufacturer

Manufacturer	Black prince
Hull ID No.	GBBPHB100E2005
Build date	2005

Original steel thickness

Base	10
Hull	6
Cabin	4

Anodes

Fitted	YES
Date fitted	2024
Size	2.5
No. of anodes	4

Material

Base	Steel
Hull	--
Cabin side	--
Roof	--

Hull blacking

Last hull blacking	2024
Where	Ashby narrow boat company



**Running gear****Engine**

Make	Isuzu
Model	42HP
Year	2005
Fuel	diesel
Cooling	skin tank
Hours	9760
Last serviced date	2025 Oct
Last serviced by	owner

Gearbox

Make	PRM
Model	150
Year	--
Reduction	--
Coupling	--
Shaft diameter	--
Propellor size	--

Capacities

Fuel	200
Water	500
Gas type	LPG

No. of gas cylinders	2
Gas cylinder size	13kg

Interior**Fitted**

Fitted by	Shakespeare
Date fitted	2005

Materials used

Floor	Carpet
Hull sides	Carpet
Cabin sides	Vinyl
Deckhead	--
Bulkheads	Wood
Fittings	--





Equipment

In the galley

Cooker type	Thetford
Cooker model	Caprice
Fridge type	Inlander
Fridge model	--
Other	--

Heating

Type	Eberspacher
Make	--
Model	--
Fuel	Diesel
Other remarks	Hydronic- D4WSC

Hot water

Type	Calorifier
Make	--
Model	--
Fuel	Diesel
Other remarks	--
Additional heating	CO alarm and Smoke alarm fitted Tested April 2025

In the bathroom

Bath	--
Shower	yes
Hip bath	--
Basin	yes
Toilet type	Macerater
Toilet make	Sanimarin
Toilet model	SN43
Toilet tank capacity	1000
Toilet remarks	Brand new toilet Glass shower screen

Electrical systems

DC voltage	--
No. of batteries (start)	1
No. of batteries (domestic)	3
Split charging	--
Other	--

240 volt electrical systems

Inverter make	Sterling
Inverter rating	1500w
Generator make	--
Generator rating	--
Shoreline	YES
Other	--

Additional information

--

