



Merry Mallard

Aldermaston Wharf

£27,950.00

A 30ft 1999 Ledgard Bridge 3 berth cruiser stern narrowboat

Merry Mallard is a wonderful 30ft cruiser stern narrowboat, perfect for weekend getaways or relaxed cruising. Painted in an attractive blue and grey colour scheme, she's a compact and cosy craft with a practical layout and plenty of character.

Step aboard from the stern into a rear cabin featuring a bench seat that easily converts into a single bed – ideal for guests or a quiet spot to relax. Moving forward, you'll find a convenient WC with toilet and basin, opposite a separate shower for added flexibility.

The galley is well-equipped with a cooker, hob, fridge, and sink – everything you need to whip up a meal while afloat.

At the front of the boat, the saloon offers comfortable sofa seating with a removable table, converting into a sleeping area when night falls. Glazed doors open onto the bow deck – the perfect spot for morning coffees or evening sunsets.

Whether you're a first-time boater or looking for a manageable-sized craft to enjoy the canals, Merry Mallard is a lovely little boat ready for new adventures.

Merry Mallard has a Boat Safety Certificate, valid until March 2028.

To arrange a viewing or for further information, please contact Aldermaston Wharf on 01189 714123.

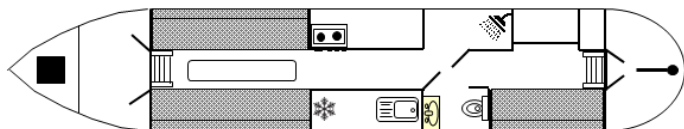

Overall length	30 feet
Beam	6 feet 6 inches
Draft	1 feet 9 inches
Headroom	--
No. of berths	3
Style of stern	--
BSS certificate expiry	--
Built	In 1999 by Ledgard bridge
Fitout	In 1999 by Leadgard bridge
Base	steel
Hull	steel 10mm
Cabin	steel 10mm
Engine	beta 3 cylinder
Gearbox	--





Scan the QR code to view online





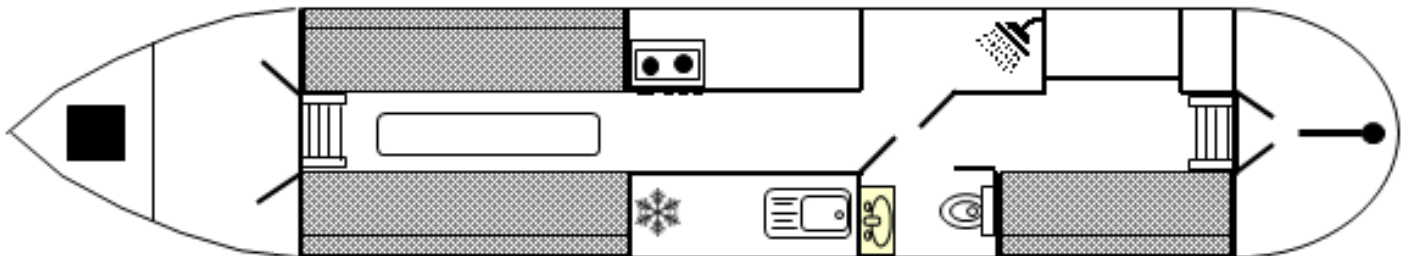

**General****General**

Name	Merry Mallard
BW index number	515414
Safety certificate	YES
BSS certificate expiry	--
BSS certificate number	45350/23
Built	In 1999 by Ledgard bridge
Location	Aldermaston Wharf
Price	£27,950.00

Berths

No. of Berths	3
Double beds	--
Double beds (temp)	1
Single beds	--
Single beds (temp)	1

Size

Overall length	30 feet
Overall beam	6 feet 6 inches
Overall draft	1 feet 9 inches
Style of stern	--

Structure**Manufacturer**

Manufacturer	Ledgard bridge
Hull ID No.	--
Build date	1999

Original steel thickness

Base	--
Hull	10mm
Cabin	10mm

Anodes

Fitted	NO
Date fitted	2021
Size	--
No. of anodes	4

Material

Base	steel
Hull	steel
Cabin side	steel
Roof	steel

Hull blacking

Last hull blacking	2021
Where	--



**Running gear****Engine**

Make	beta
Model	3 cylinder
Year	1999
Fuel	diesel
Cooling	--
Hours	016067
Last serviced date	2024
Last serviced by	Paul Hutley

Gearbox

Make	--
Model	--
Year	--
Reduction	--
Coupling	--
Shaft diameter	--
Propellor size	1.5

Capacities

Fuel	375ltr
Water	900ltr
Gas type	propane

No. of gas cylinders	2
Gas cylinder size	13k

Interior**Fitted**

Fitted by	Leadgard bridge
Date fitted	1999

Materials used

Floor	wood
Hull sides	wood
Cabin sides	wood
Deckhead	--
Bulkheads	--
Fittings	--



**Equipment****In the galley**

Cooker type	yes
Cooker model	--
Fridge type	yes
Fridge model	--
Other	--

Heating

Type	Aldi boiler
Make	--
Model	--
Fuel	--
Other remarks	not working

Hot water

Type	calorifier
Make	--
Model	--
Fuel	--
Other remarks	--
Additional heating	--

In the bathroom

Bath	--
Shower	yes
Hip bath	--
Basin	yes
Toilet type	cassette
Toilet make	--
Toilet model	--
Toilet tank capacity	--
Toilet remarks	--

Electrical systems

DC voltage	--
No. of batteries (start)	1
No. of batteries (domestic)	2
Split charging	--
Other	--

240 volt electrical systems

Inverter make	240
Inverter rating	300watt
Generator make	--
Generator rating	--
Shoreline	YES
Other	--

Additional information

--

