



Kate

Gayton Marina

£51,000.00

A 62ft 1990 Les Allen & Sons 3 berth traditional stern narrowboat.

Meet Kate, a beautifully crafted 62ft traditional stern narrowboat built in 1990 by the highly regarded Les Allen & Sons. With her warm wooden interior and classic lines, Kate has a timeless charm and a layout that offers both comfort and practicality—perfect for life afloat, weekend getaways, or long-term cruising.

Entering from the stern, you'll find an engine room that also serves as a handy storage space. Moving forward, the boat opens into a peaceful bedroom with a fixed double bed, ideal for a restful night on the water.

The bathroom follows, equipped with a shower, basin, and toilet, offering all the essential facilities in a compact, well-designed space. Just beyond is a small but useful utility room, fitted with a fridge and washing machine—making extended stays on board all the more convenient.

The central saloon area provides a cosy retreat, featuring two comfortable swivel easy chairs and a TV, perfect for relaxing with a book or film.

Kate's galley is well laid out, with a sink and drainer unit, a diesel range cooker, ample worktop space, and plenty of undercounter storage. It's a practical and welcoming area for preparing meals while enjoying life afloat.

The dinette is situated at the front of the boat and offers an inviting space with an L-shaped sofa, a second TV, and a diesel stove for warmth and atmosphere. At the bow, you step out onto a cratch covered deck with built-in bench seating on either side—a lovely spot for morning coffee or evening drinks, surrounded by nature.

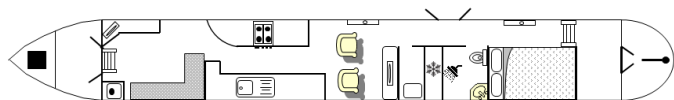

Overall length	62 feet
Beam	6 feet 10 inches
Draft	2 feet 5 inches
Headroom	6 feet 1 inches
No. of berths	3
Style of stern	
BSS certificate expiry	--
Built	In 1990 by Les Allen and Sons
Fitout	Les Allen and Sons / Grist Mill
Base	Steel 10mm
Hull	Steel 6mm
Cabin	Steel 5mm
Engine	Perkins D31152 40 HP DIESEL
Gearbox	Newage PRM 160





Kate is a solid, characterful boat, ready to offer her next owner a unique lifestyle on the water. Whether you're seeking a liveaboard or a weekend escape, she's a vessel that blends tradition with the comforts of home.

Kate has Boat Safety Certificate, valid until September 2028.

To arrange a viewing or for further information, please contact Gayton Marina on 01604 858685. Moorings are available at Gayton and can be discussed with the marina directly.

Additional information

Survey carried out in 2023 can be viewed in shop but we do always recommend buyers to have their own independent survey

Condition of boat is good

Scan the QR code to view online





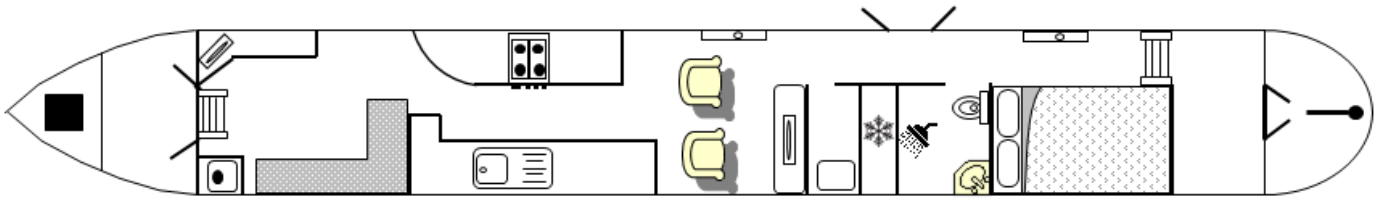



General

General

Name	Kate
BW index number	G230744
Safety certificate	YES
BSS certificate expiry	--
BSS certificate number	bsser-488423/24
Built	In 1990 by Les Allen and Sons
Location	Gayton Marina
Price	£51,000.00

Berths

No. of Berths	3
Double beds	1
Double beds (temp)	--
Single beds	1
Single beds (temp)	--

Size

Overall length	62 feet
Overall beam	6 feet 10 inches
Overall draft	2 feet 5 inches
Style of stern	

Structure

Manufacturer

Manufacturer	Les Allen and Sons
Hull ID No.	--
Build date	1990

Original steel thickness

Base	10mm
Hull	6mm
Cabin	5mm

Anodes

Fitted	YES
Date fitted	2023
Size	--
No. of anodes	--

Material

Base	Steel
Hull	Steel
Cabin side	Steel
Roof	Steel

Hull blacking

Last hull blacking	5th Sept 2023
Where	Blackthorn lake marina



**Running gear****Engine**

Make	Perkins
Model	D31152 40 HP DIESEL
Year	1989
Fuel	Diesel
Cooling	Skin tank
Hours	--
Last serviced date	--
Last serviced by	--

Gearbox

Make	Newage PRM
Model	160
Year	--
Reduction	2:1
Coupling	--
Shaft diameter	1.5 inches
Propellor size	--

Capacities

Fuel	--
Water	--
Gas type	--

No. of gas cylinders	--
Gas cylinder size	--

Interior**Fitted**

Fitted by	Les Allen and Sons / Grist Mill
Date fitted	--

Materials used

Floor	Carpet / Wood
Hull sides	Wood faced panels
Cabin sides	veneered ply
Deckhead	veneered ply
Bulkheads	veneered ply
Fittings	12v lighting





Equipment

In the galley

Cooker type	Dickinson diesel range
Cooker model	Pacific
Fridge type	LEC
Fridge model	--
Other	Microwave essentials C17MWIF

Heating

Type	Radiator
Make	Lockgate / Refleks
Model	Series 2000KV
Fuel	Diesel
Other remarks	--

Hot water

Type	Calorifier and engine
Make	--
Model	b3
Fuel	--
Other remarks	--
Additional heating	240 v Tubular heater and convector in mid saloon and aft cabin

In the bathroom

Bath	NO
Shower	YES with curtain screen
Hip bath	NO
Basin	YES
Toilet type	Sealand / Mansfield
Toilet make	Pumpout
Toilet model	Traveller
Toilet tank capacity	--
Toilet remarks	--

Electrical systems

DC voltage	yes
No. of batteries (start)	1
No. of batteries (domestic)	--
Split charging	True
Other	3 x solar panels 350w victron Hydraulic bow thruster

240 volt electrical systems

Inverter make	Victron Phoenix 12v/350w
Inverter rating	--
Generator make	Victron - Centaur battery charger
Generator rating	--
Shoreline	YES
Other	--





Additional information

Survey carried out in 2023 can be viewed in shop but we do always recommend buyers to have their own independent survey Condition of boat is good

