



Jessica

Goytre Wharf

£17,500.00

A 30ft 1979 Hancock & Lane 2 berth cruiser stern narrowboat.

This sweet little boat is an excellent size for holidays, weekends and lazy days on the water.

In 2023 Jessica was treated to a new engine, exterior paintwork and hull blacking, plus the addition of 4 anodes. A smart pram-hood protects the stern deck.

Internally there are also new carpets and curtains.

Entering from the rear there is a wetroom to the left with smart brick-effect wall panelling, rainfall shower, washbasin and wc.

There is an open plan galley/living/sleeping area, containing plentiful cupboard space, seating that converts to provide a double bed, a sink and hob, and windows opening out to the bow.

Jessica is powered by a Craftsman diesel engine. There is one leisure and one starter battery and a shoreline socket to enable mains to be supplied.

Please contact Goytre Wharf on 01873 880516 to arrange a viewing!

Additional information

Exterior painted in August 2023 by Cooper Marine. Interior in good condition - new carpets, curtains and cushions.

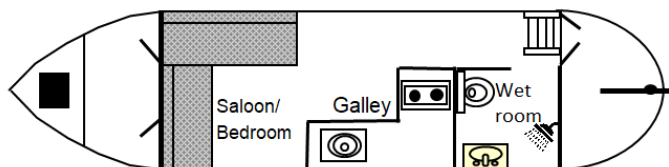

Overall length	30 feet
Beam	6 feet 10 inches
Draft	2 feet
Headroom	--
No. of berths	2
Style of stern	
BSS certificate expiry	--
Built	In 1979 by Hancock & Lane
Fitout	In 2023 by Cooper Marine / Vendor
Base	Steel
Hull	Steel
Cabin	Steel
Engine	Craftsman CM2.16
Gearbox	PRM 800 2:1





Scan the QR code to view online





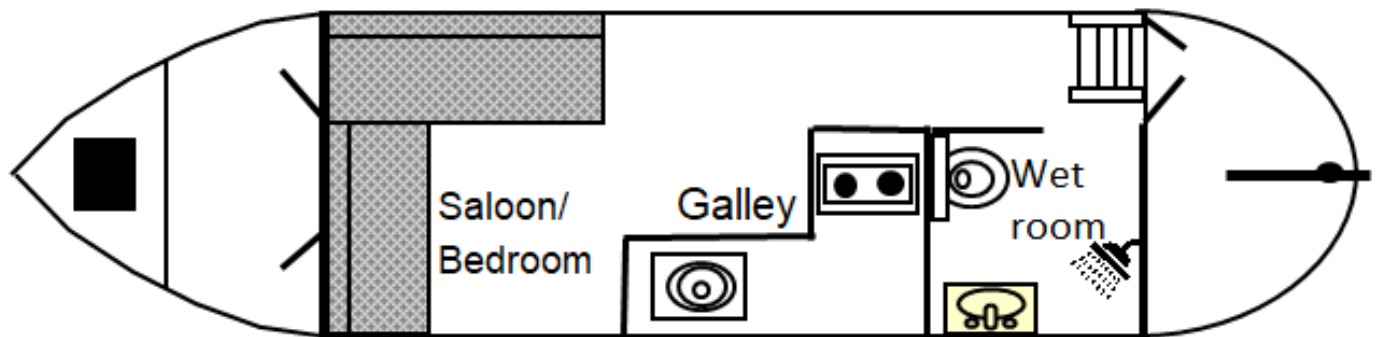



General

General

Name	Jessica
BW index number	68160
Safety certificate	NO
BSS certificate expiry	--
BSS certificate number	BSSER-462971/23
Built	In 1979 by Hancock & Lane
Location	Goytre Wharf
Price	£17,500.00

Berths

No. of Berths	2
Double beds	--
Double beds (temp)	1
Single beds	--
Single beds (temp)	--

Size

Overall length	30 feet
Overall beam	6 feet 10 inches
Overall draft	2 feet
Style of stern	

Structure

Manufacturer

Manufacturer	Hancock & Lane
Hull ID No.	--
Build date	1979

Original steel thickness

Base	--
Hull	--
Cabin	--

Anodes

Fitted	YES
Date fitted	2023
Size	--
No. of anodes	4

Material

Base	Steel
Hull	Steel
Cabin side	Steel
Roof	Steel

Hull blacking

Last hull blacking	2023-08
Where	Herons Rest



**Running gear****Engine**

Make	Craftsman
Model	CM2.16
Year	2023
Fuel	Diesel
Cooling	Skin Tank
Hours	15
Last serviced date	--
Last serviced by	--

Gearbox

Make	PRM
Model	800 2:1
Year	--
Reduction	2:1
Coupling	--
Shaft diameter	--
Propellor size	--

Capacities

Fuel	--
Water	100 Litres
Gas type	--

No. of gas cylinders	--
Gas cylinder size	--

Interior**Fitted**

Fitted by	Cooper Marine / Vendor
Date fitted	2023

Materials used

Floor	Ply
Hull sides	Ply
Cabin sides	Ply
Deckhead	--
Bulkheads	Ply
Fittings	--



**Equipment****In the galley**

Cooker type	Integral hob
Cooker model	Karinear KNG PF3205GB
Fridge type	--
Fridge model	--
Other	--

Heating

Type	--
Make	--
Model	--
Fuel	--
Other remarks	--

Hot water

Type	Gas
Make	--
Model	--
Fuel	--
Other remarks	Working condition
Additional heating	--

In the bathroom

Bath	--
Shower	Yes
Hip bath	--
Basin	Yes
Toilet type	Yes
Toilet make	--
Toilet model	--
Toilet tank capacity	--
Toilet remarks	Glass screen

Electrical systems

DC voltage	12v
No. of batteries (start)	1
No. of batteries (domestic)	2
Split charging	--
Other	--

240 volt electrical systems

Inverter make	--
Inverter rating	--
Generator make	--
Generator rating	--
Shoreline	YES
Other	--

Additional information

Exterior painted in August 2023 by Cooper Marine. Interior in good condition - new carpets, curtains and cushions.

