



Ho Hum

Gayton Marina

£36,000.00

A 46ft 1988 Springer 4 berth cruiser stern narrowboat

Step aboard Ho-Hum, a beautifully presented boat that perfectly blends modern comfort with distinctive, eye-catching decor. Its bright, thoughtfully designed interior offers both practicality and personality, making it an inviting space for relaxing or entertaining.

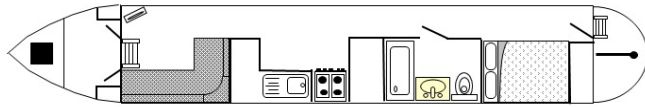

Entering from the stern, you are welcomed into the master bedroom, featuring a double bed and some storage. Moving forward through the charming, decorative hallway, you'll find a well-appointed bathroom complete with a hip bath and overhead shower, wash basin, vanity unit, and a pump-out toilet.

The boat then opens into a functional U-shaped galley, designed for ease of use and efficiency. Here you'll find a cooker, built-in fridge, sink with drainer, and attractive cream-tiled work surfaces, providing ample space for food preparation. A side hatch in this area adds both light and ventilation.

At the bow, the welcoming saloon offers a practical seating area that easily converts into a temporary double bed, making it perfect for guests. Throughout the boat, portholes and windows flood the interior with natural light, enhancing the airy atmosphere. The white panelled finish, complemented by navy lower walls and quirky wallpaper, gives Ho-Hum its unique, contemporary charm.

A Boat Acceptance Certificate is valid until August 2029.

To make an enquiry or arrange to view, please contact Gayton Marina on 01604 858685.

Overall length	46 feet
Beam	--
Draft	--
Headroom	--
No. of berths	4
Style of stern	
BSS certificate expiry	--
Built	In 1988 by Springer
Fitout	
Base	Steel 6mm
Hull	Steel 5mm
Cabin	Steel 3mm
Engine	BMC 1.8
Gearbox	PRM Delta 20





Scan the QR code to view online





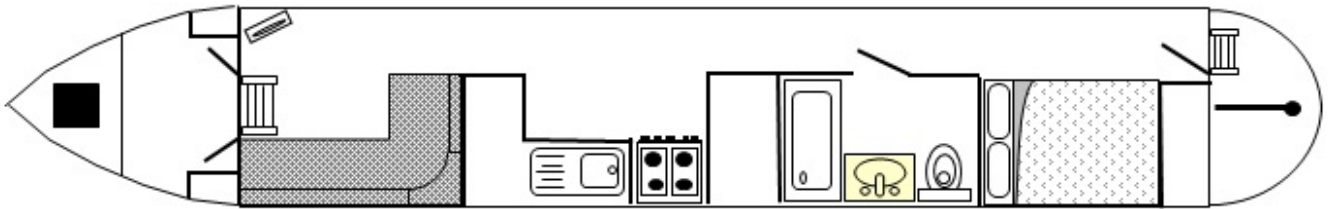

**General**

General

Name	Ho Hum
BW index number	45859
Safety certificate	YES
BSS certificate expiry	--
BSS certificate number	509323/25
Built	In 1988 by Springer
Location	Gayton Marina
Price	£36,000.00

Berths

No. of Berths	4
Double beds	1
Double beds (temp)	1
Single beds	--
Single beds (temp)	--

Size

Overall length	46 feet
Overall beam	--
Overall draft	--
Style of stern	

Structure

Manufacturer

Manufacturer	Springer
Hull ID No.	--
Build date	1988

Original steel thickness

Base	6mm
Hull	5mm
Cabin	3mm

Anodes

Fitted	YES
Date fitted	2021
Size	--
No. of anodes	4

Material

Base	Steel
Hull	Steel
Cabin side	Steel
Roof	Steel

Hull blacking

Last hull blacking	06/10/2025
Where	Stowe Hill



**Running gear****Engine**

Make	BMC
Model	1.8
Year	--
Fuel	--
Cooling	--
Hours	--
Last serviced date	06/10/2025
Last serviced by	Stowe Hill

Gearbox

Make	PRM
Model	Delta 20
Year	--
Reduction	--
Coupling	--
Shaft diameter	--
Propellor size	--

Capacities

Fuel	Diesel
Water	--
Gas type	Butane

No. of gas cylinders	2
Gas cylinder size	13kg

Interior**Fitted**

Fitted by	--
Date fitted	--

Materials used

Floor	Vinyl and carpet
Hull sides	Plywood
Cabin sides	Parma Pine tongue and groove
Deckhead	--
Bulkheads	--
Fittings	--



**Equipment****In the galley**

Cooker type	Statesman
Cooker model	--
Fridge type	Electrolux
Fridge model	--
Other	Dishwasher and TV included

Heating

Type	Frost Bar
Make	--
Model	240v
Fuel	240v
Other remarks	In working order

Hot water

Type	Tank
Make	--
Model	--
Fuel	--
Other remarks	Tank is insulated and galvanised Water is heated from engine
Additional heating	CO2 alarm fitted

In the bathroom

Bath	--
Shower	1
Hip bath	1
Basin	--
Toilet type	Pumpout
Toilet make	--
Toilet model	--
Toilet tank capacity	--
Toilet remarks	--

Electrical systems

DC voltage	12
No. of batteries (start)	1
No. of batteries (domestic)	1
Split charging	True
Other	110A

240 volt electrical systems

Inverter make	--
Inverter rating	--
Generator make	--
Generator rating	--
Shoreline	YES
Other	--

Additional information

--

