

| | |
|------------------------|---|
| Overall length | 59 feet 6 inches |
| Beam | 6 feet 10 inches |
| Draft | 2 feet |
| Headroom | -- |
| No. of berths | 6 |
| Style of stern | |
| BSS certificate expiry | -- |
| Built | In 2009 by G and J Reeves |
| Fitout | In 2009 by JD Boat Services Gailey LTD |
| Base | Steel 10 |
| Hull | Steel 6 |
| Cabin | Steel 4 |
| Engine | Barrus Shire 40 |
| Gearbox | Newage PRM 150 |

Heron

Gailey Wharf

£59,950.00

A 59ft 6inches 2009 G and J Reeves 6 berth semi traditional stern narrowboat. Available 1st February 2026.

Heron is a charming and practical narrowboat, measuring 59ft with a semi-traditional stern, offering a well-thought-out layout ideal for both liveaboard life and extended cruising. Designed with comfort and versatility in mind, Heron features multiple sleeping arrangements, efficient use of space, and all the essentials for life on the water.

Upon descending the stern steps, you enter the rear cabin, which can be configured as either a double berth or two singles, depending on your needs. This room includes under-bed storage and a shelf, making it a flexible and functional space for guests or family members. Moving forward, the bathroom is equipped with a toilet, hand basin, and a shower—compact yet practical for everyday use.

The mid-cabin features a fixed double berth with a shelf above the bed, offering a cosy and private sleeping area with additional storage options. This leads into the galley, which is well-equipped with a four-burner hob, sink, microwave, and an under-counter fridge. The layout makes excellent use of space, providing everything needed to prepare meals while on board.

Continuing through the boat, you arrive at the saloon—a warm and inviting space with a log burner and generous seating. This area is perfect for relaxing or entertaining, and it can also be converted into an additional sleeping area, offering either a single or a double berth. Radiators are fitted throughout the boat, ensuring a comfortable temperature year-round.





Heron offers a great combination of comfort and practicality. Whether you're looking for a weekend escape or a full-time floating home on the Staffordshire and Worcestershire Canal, Heron is ready to welcome you aboard.

A Boat Safety Certificate (BSS) is valid until July 2029.

For viewings or more information please contact Gailey Wharf on 01902 790612.

Scan the QR code to view online





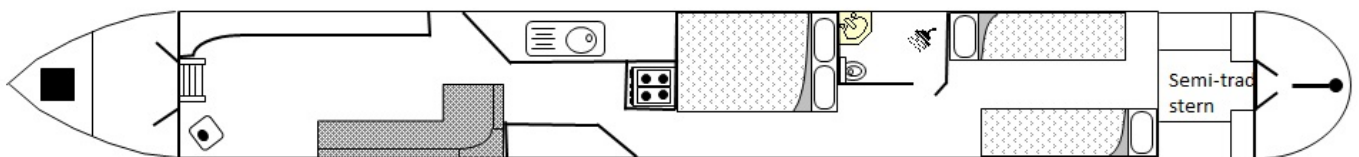



General

General

| | |
|------------------------|---------------------------|
| Name | Heron |
| BW index number | 518030 |
| Safety certificate | YES |
| BSS certificate expiry | -- |
| BSS certificate number | BSSER-506695/25 |
| Built | In 2009 by G and J Reeves |
| Location | Gailey Wharf |
| Price | £59,950.00 |

Berths

| | |
|--------------------|----|
| No. of Berths | 6 |
| Double beds | 1 |
| Double beds (temp) | 2 |
| Single beds | -- |
| Single beds (temp) | -- |

Size

| | |
|----------------|------------------|
| Overall length | 59 feet 6 inches |
| Overall beam | 6 feet 10 inches |
| Overall draft | 2 feet |
| Style of stern | |

Structure

Manufacturer

| | |
|--------------|----------------|
| Manufacturer | G and J Reeves |
| Hull ID No. | GBJDBDN140909 |
| Build date | 2009 |

Original steel thickness

| | |
|-------|----|
| Base | 10 |
| Hull | 6 |
| Cabin | 4 |

Anodes

| | |
|---------------|-------|
| Fitted | YES |
| Date fitted | 2021 |
| Size | 3.5kg |
| No. of anodes | 4 |

Material

| | |
|------------|-------|
| Base | Steel |
| Hull | Steel |
| Cabin side | Steel |
| Roof | Steel |

Hull blacking

| | |
|--------------------|----------------------|
| Last hull blacking | 2021-09 |
| Where | Canal Cruising Stone |



**Running gear****Engine**

| | |
|--------------------|-----------------------------|
| Make | Barrus |
| Model | Shire 40 |
| Year | 2016 |
| Fuel | Diesel |
| Cooling | Skin Tank |
| Hours | -- |
| Last serviced date | -- |
| Last serviced by | JD Boat Services Gailey LTD |

Gearbox

| | |
|----------------|------------------|
| Make | Newage |
| Model | PRM 150 |
| Year | -- |
| Reduction | 3:1 |
| Coupling | Python Drive P60 |
| Shaft diameter | 1.5 |
| Propellor size | 18 X 16 |

Capacities

| | |
|----------|---------|
| Fuel | 228L |
| Water | 665L |
| Gas type | Propane |

| | |
|----------------------|------|
| No. of gas cylinders | 2 |
| Gas cylinder size | 13kg |

Interior**Fitted**

| | |
|-------------|-----------------------------|
| Fitted by | JD Boat Services Gailey LTD |
| Date fitted | 2009 |

Materials used

| | |
|-------------|-----------------|
| Floor | 18mm ply |
| Hull sides | 9mm Ply |
| Cabin sides | 9mm Ply |
| Deckhead | 9mm Ply |
| Bulkheads | 18mm Blockboard |
| Fittings | Brass |





Equipment

In the galley

| | |
|--------------|---------------|
| Cooker type | Stoves |
| Cooker model | 500DIT |
| Fridge type | Under Counter |
| Fridge model | -- |
| Other | Microwave |

Heating

| | |
|---------------|-------------|
| Type | Radiators |
| Make | Everspacher |
| Model | D4W |
| Fuel | Diesel |
| Other remarks | -- |

Hot water

| | |
|--------------------|---|
| Type | Valorifier |
| Make | Eberspacher and Engine |
| Model | 55IT |
| Fuel | Diesel |
| Other remarks | -- |
| Additional heating | Boatman Solid Fuel in the Saloon last serviced in 2025. |

In the bathroom

| | |
|----------------------|-------------------------------------|
| Bath | -- |
| Shower | Yes |
| Hip bath | -- |
| Basin | Yes |
| Toilet type | Macerator |
| Toilet make | Sani-Nauti-Co |
| Toilet model | SN35 |
| Toilet tank capacity | 425L |
| Toilet remarks | WC has 300L capacity flushing tank. |

Electrical systems

| | |
|-----------------------------|-------------------------|
| DC voltage | 12 |
| No. of batteries (start) | 1 |
| No. of batteries (domestic) | 4 |
| Split charging | True |
| Other | 2 x Boiler Batteries 6v |

240 volt electrical systems

| | |
|------------------|--------------------------|
| Inverter make | Victron Multi Plus Combi |
| Inverter rating | 3000VA |
| Generator make | -- |
| Generator rating | -- |
| Shoreline | YES |
| Other | -- |

Additional information

--

