



Eric's Girl

Alvechurch
Marina

£43,500

A 57ft 2008 Mike Christian 5 berth traditional stern narrowboat.

This boat was built in a lovingly traditional style, and features substantial solid wood fittings throughout, giving her a warm and rustic feel.

From the stern the Boatmans' cabin has plenty of space for keeping equipment. Steps lead down to a double bedroom with storage underneath, followed by a walk through shower room with a large Quadrant shower with curved glass doors and a circular washbasin on an American Black Walnut shelf.

Further forward is a Pullman dinette area which will convert to a double berth and then the kitchen with its modern stainless steel fittings, integral hob and oven and under counter fridge.

Finally a comfortable saloon area holds a large sofa and a solid fuel stove.

Portholes throughout and a central side-hatch add to the traditional feel of this boat.

To make an enquiry, please contact Alvechurch Marina on 0121 445 1133.

Scan the QR code to view online

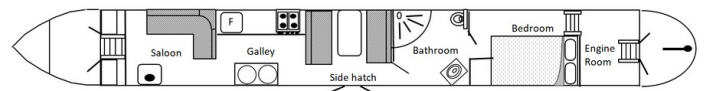

Overall length	57 feet
Beam	6 feet 10 inches
Draft	2 feet 6 inches
Headroom	--
No. of berths	5
Style of stern	Traditional
BSS certificate expiry	9th January 2028
Built	In 2008 by Mike Christian
Fitout	
Base	Steel 10mm
Hull	Steel 6mm
Cabin	Steel 5mm
Engine	Isuzu 42
Gearbox	--





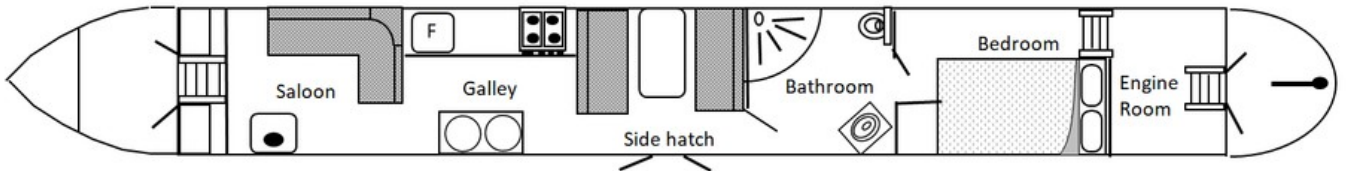



General

General

Name	Eric's Girl
BW index number	517032
Safety certificate	YES
BSS certificate expiry	9th January 2028
BSS certificate number	BSSER-473174/24
Built	In 2008 by Mike Christian
Location	Alvechurch Marina
Price	£43,500

Berths

No. of Berths	5
Double beds	1
Double beds (temp)	1
Single beds	--
Single beds (temp)	1

Size

Overall length	57 feet
Overall beam	6 feet 10 inches
Overall draft	2 feet 6 inches
Style of stern	Traditional

Structure

Manufacturer

Manufacturer	Mike Christian
Hull ID No.	--
Build date	2008

Original steel thickness

Base	10mm
Hull	6mm
Cabin	5mm

Anodes

Fitted	YES
Date fitted	2020
Size	--
No. of anodes	--

Material

Base	Steel
Hull	Steel
Cabin side	Steel
Roof	Steel

Hull blacking

Last hull blacking	2020
Where	--





Running gear

Engine

Make	Isuzu
Model	42
Year	2008
Fuel	Diesel
Cooling	--
Hours	--
Last serviced date	2022
Last serviced by	--

Gearbox

Make	--
Model	--
Year	--
Reduction	--
Coupling	--
Shaft diameter	--
Propellor size	--

Capacities

Fuel	--
Water	--
Gas type	--

No. of gas cylinders	--
Gas cylinder size	--

Interior

Fitted

Fitted by	--
Date fitted	--

Materials used

Floor	Oak
Hull sides	--
Cabin sides	--
Deckhead	--
Bulkheads	--
Fittings	--





Equipment

In the galley

Cooker type	Hob, grill and oven
Cooker model	New World/Smeg
Fridge type	Under counter
Fridge model	--
Other	--

Heating

Type	Central heating
Make	Webasto
Model	--
Fuel	Diesel
Other remarks	--

Hot water

Type	Calorifier
Make	--
Model	--
Fuel	--
Other remarks	--
Additional heating	Solid fuel stove in saloon

In the bathroom

Bath	--
Shower	Yes
Hip bath	--
Basin	Yes
Toilet type	Cassette
Toilet make	--
Toilet model	--
Toilet tank capacity	--
Toilet remarks	--

Electrical systems

DC voltage	--
No. of batteries (start)	--
No. of batteries (domestic)	--
Split charging	--
Other	--

240 volt electrical systems

Inverter make	Victron Phoenix Multi-Plus
Inverter rating	--
Generator make	--
Generator rating	--
Shoreline	YES
Other	--

Other

Additional information

--

