



Overall length	64 feet
Beam	6 feet 10 inches
Draft	--
Headroom	--
No. of berths	8
Style of stern	
BSS certificate expiry	--
Built	In 1996 by Stephen Goldsbrough Boats
Fitout	In 1996 by Stephen Goldsbrough Boats
Base	Steel 10mm
Hull	Steel 6mm
Cabin	Steel 4mm
Engine	Beta 43
Gearbox	PRM 160 D2

Elegance

Fenny Marina

£59,950.00

A 64ft 1996 Stephen Goldsbrough Boats 8 berth cruiser stern narrowboat.

This eye-catching narrowboat features a classic navy blue exterior with refined gold trim, offering timeless style and standout presence on the water. Large saloon windows provide sweeping views and flood the interior with natural light, making this vessel ideal for both cruising and relaxing moored up.

Entering from the stern, you're welcomed into a twin bedroom with two single beds, dressed in a tasteful navy and cream colour scheme. Porthole windows add charm and privacy, while oak plywood detailing on the doors and cabinetry adds warmth and continuity throughout the boat.

Next, you'll find a compact shower room with the toilet opposite, cleverly enclosed by opposing doors to form a private bathroom compartment.

Continuing forward, you enter the first of two double bedrooms, each featuring a wardrobe and continuing the elegant navy and cream palette. The oak ply finish flows seamlessly across walls, doors, and built-in furniture, creating a cohesive and inviting atmosphere.

The second double bedroom mirrors the first, with porthole windows and a wardrobe, offering comfortable accommodation for guests or family.

The next space is a full bathroom, complete with a vanity unit, wash basin, toilet, and a bath with overhead shower.

Moving into the heart of the boat, the fully equipped galley includes an oven, sink, fridge, counter space, and





overhead cupboards, making meal preparation a pleasure whether you're moored or cruising.

Finally, the saloon offers two long bench seats that double as single beds, creating an extra bedroom. This area transforms into a dining space with a removable table, perfect for socialising or enjoying meals with a view through the large windows.

Elegance has a Boat Safety Certificate, valid until August 2028.

Viewing is highly recommended. To make an enquiry or arrange to view, please call Fenny Marina on 01527 876438.

Scan the QR code to view online







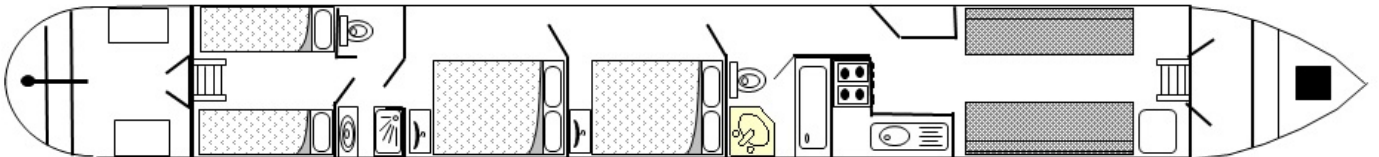



General

General

Name	Elegance
BW index number	500553
Safety certificate	YES
BSS certificate expiry	--
BSS certificate number	--
Built	In 1996 by Stephen Goldsbrough Boats
Location	Fenny Marina
Price	£59,950.00

Berths

No. of Berths	8
Double beds	2
Double beds (temp)	--
Single beds	2
Single beds (temp)	2

Size

Overall length	64 feet
Overall beam	6 feet 10 inches
Overall draft	--
Style of stern	

Structure

Manufacturer

Manufacturer	Stephen Goldsbrough Boats
Hull ID No.	--
Build date	1996

Original steel thickness

Base	10mm
Hull	6mm
Cabin	4mm

Anodes

Fitted	YES
Date fitted	2023
Size	2.5kg
No. of anodes	4

Material

Base	Steel
Hull	Steel
Cabin side	Steel
Roof	Steel

Hull blacking

Last hull blacking	2023-09
Where	Braunston





Running gear

Engine

Make	Beta
Model	43
Year	2011
Fuel	Deisel
Cooling	Keel
Hours	--
Last serviced date	2025-01
Last serviced by	Kate Boats Warwick

Gearbox

Make	PRM
Model	160 D2
Year	--
Reduction	2:1
Coupling	Centre flex
Shaft diameter	--
Propellor size	--

Capacities

Fuel	250 litres
Water	660 litres
Gas type	Propane

No. of gas cylinders	2
Gas cylinder size	13kg

Interior

Fitted

Fitted by	Stephen Goldsbrough Boats
Date fitted	1996

Materials used

Floor	Ply
Hull sides	Oak ply
Cabin sides	Oak ply
Deckhead	Oak ply
Bulkheads	Oak ply
Fittings	Oak ply



**Equipment****In the galley**

Cooker type	--
Cooker model	Statesman Legacy
Fridge type	--
Fridge model	--
Other	--

Heating

Type	Central heating radiators
Make	Webasto
Model	Thermo top
Fuel	--
Other remarks	Newly fitted April 2024

Hot water

Type	Calorifier
Make	--
Model	--
Fuel	Diesel
Other remarks	--
Additional heating	--

In the bathroom

Bath	Yes
Shower	Yes
Hip bath	--
Basin	Yes
Toilet type	Pump out x 2
Toilet make	Tecma
Toilet model	--
Toilet tank capacity	310 litres
Toilet remarks	--

Electrical systems

DC voltage	12v
No. of batteries (start)	--
No. of batteries (domestic)	--
Split charging	--
Other	--

240 volt electrical systems

Inverter make	Sterling
Inverter rating	1800
Generator make	--
Generator rating	--
Shoreline	NO
Other	--

Additional information

--

