



## Corrigair

Aldermaston Wharf

£74,950.00

A 70ft 2004 Barry Hawkins 7 berth semi traditional stern narrowboat.

Corrigair is a beautifully appointed 70ft semi-traditional stern narrowboat, thoughtfully designed to offer comfort, flexibility, and style for life on the water. From the moment you step aboard, you'll appreciate the clever use of space and the inviting atmosphere that makes Corrigair a perfect choice for both leisure cruising and extended stays.

To enhance manoeuvrability, Corrigair is fitted with a VETUS 55KGT bow thruster, offering excellent control when navigating tight spaces or mooring. This powerful system adds a layer of confidence and ease, especially for solo cruisers or those new to narrowboating. Corrigair also has solar panels fitted to the roof.

Entering from the stern, you're welcomed into the rear bedroom—a versatile space featuring a double bed that conveniently folds out when needed. When not in use as a sleeping area, it transforms into a comfortable seating nook, ideal for relaxing or reading. This room sets the tone for the boat's smart design, offering both functionality and comfort.

Moving forward, you'll find a compact toilet and hand basin, providing convenience for guests and day-to-day use. The heart of the boat unfolds next with the saloon, dinette, and galley arranged in an open-plan layout that maximizes space and light. The saloon is warm and inviting, complete with a stove for cosy evenings and a variety of built-in storage options to keep everything tidy and accessible.

Adjacent to the saloon is the dinette, which features charming side hatch openings that bring in natural light and fresh air. The dinette also converts into a bed,

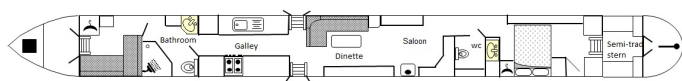

Overall length	70 feet
Beam	6 feet 10 inches
Draft	2 feet 1 inches
Headroom	--
No. of berths	7
Style of stern	
BSS certificate expiry	--
Built	In 2004 by Barry Hawkins
Fitout	In 2004 by D Prentice, Prentice Furniture
Base	Steel 10
Hull	Steel 6
Cabin	Steel 4
Engine	Barrus Shire 45
Gearbox	PRM 15002





offering additional sleeping space, and includes discreet storage compartments to keep essentials close at hand. This area is perfect for dining, entertaining, or simply enjoying the view.

The galley is a standout feature of Corrigair, boasting a sleek white worktop and smart storage solutions that make the most of the compact space. It's fully equipped with a full-sized fridge, a dishwasher, washing machine and a four-burner hob—ideal for preparing meals whether you're moored up or cruising.

Further along, the bathroom offers a well-appointed shower, toilet, and hand basin, providing all the comforts of home in a stylish and efficient layout. Finally, at the bow of the boat, you'll find a flexible seating area that easily converts into a temporary bed, perfect for accommodating guests. This space also includes a wardrobe, adding to the boat's generous storage options.

Corrigair is a thoughtfully designed narrowboat that combines practicality with charm, making it an excellent choice for anyone looking to enjoy the waterways in comfort and style.

To arrange a viewing or for more information, please contact Aldermaston Wharf on 01189 714123.

Scan the QR code to view online









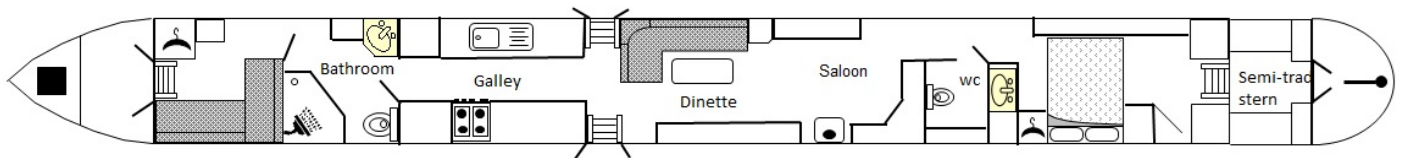

**General****General**

Name	Corrigair
BW index number	509232
Safety certificate	YES
BSS certificate expiry	--
BSS certificate number	BSSER-454020/23
Built	In 2004 by Barry Hawkins
Location	Aldermaston Wharf
Price	£74,950.00

**Berths**

No. of Berths	7
Double beds	1
Double beds (temp)	2
Single beds	--
Single beds (temp)	1

**Size**

Overall length	70 feet
Overall beam	6 feet 10 inches
Overall draft	2 feet 1 inches
Style of stern	

**Structure****Manufacturer**

Manufacturer	Barry Hawkins
Hull ID No.	GBRYA01282H404
Build date	2004

**Original steel thickness**

Base	10
Hull	6
Cabin	4

**Anodes**

Fitted	YES
Date fitted	--
Size	3k + 2.5
No. of anodes	12 + 2

**Material**

Base	Steel
Hull	Steel
Cabin side	Steel
Roof	Steel

**Hull blacking**

Last hull blacking	2021
Where	--



**Running gear****Engine**

Make	Barrus
Model	Shire 45
Year	--
Fuel	Diesel
Cooling	Tank
Hours	--
Last serviced date	2022
Last serviced by	--

**Gearbox**

Make	PRM
Model	15002
Year	--
Reduction	2:1
Coupling	--
Shaft diameter	38mm
Propellor size	--

**Capacities**

Fuel	--
Water	680ltr
Gas type	2

No. of gas cylinders	2
Gas cylinder size	6kg

**Interior****Fitted**

Fitted by	D Prentice, Prentice Furniture
Date fitted	2004

**Materials used**

Floor	Oak
Hull sides	Oak ply
Cabin sides	Oak ply
Deckhead	Oak ply
Bulkheads	Oak Ply
Fittings	Oak





## Equipment

### In the galley

Cooker type	Hob + Combi
Cooker model	--
Fridge type	Fridge + Freezer
Fridge model	--
Other	Dishwasher / washing machine

### Heating

Type	Stove
Make	Bubble
Model	--
Fuel	Diesel
Other remarks	Linked to Radiators

### Hot water

Type	Calorifier
Make	--
Model	--
Fuel	Fuel
Other remarks	--
Additional heating	--

### In the bathroom

Bath	--
Shower	Yes
Hip bath	--
Basin	2
Toilet type	Pump and Casette
Toilet make	pump out and cassette
Toilet model	--
Toilet tank capacity	--
Toilet remarks	--

### Electrical systems

DC voltage	24v
No. of batteries (start)	1
No. of batteries (domestic)	4
Split charging	True
Other	--

### 240 volt electrical systems

Inverter make	Victron
Inverter rating	3kw x 2
Generator make	--
Generator rating	--
Shoreline	YES
Other	Solar - 8x 120kw flexi panels

## Additional information

--

